



FUSION® Panel-Stereo Installation Instructions

⚠ WARNING

See the *Important Safety and Product Information* guide in the product box for product warnings and other important information.

This device must be installed according to these instructions.

Disconnect the vehicle's or vessel's power supply before beginning to install this product.

⚠ CAUTION

Continuous exposure to sound pressure levels over 100 dBA may cause permanent hearing loss. The volume is typically too loud if you cannot hear people speaking around you. Limit the amount of time you listen at high volume. If you experience ringing in your ears or muffled speech, stop listening and have your hearing checked.

Always wear safety goggles, ear protection, and a dust mask when drilling, cutting, or sanding.

NOTICE

When drilling or cutting, always check what is on the opposite side of the surface.

It is strongly recommended that you have your audio system installed by a professional installer to ensure optimum performance.

You must read all installation instructions before beginning the installation. If you experience difficulty during the installation, go to www.fusionentertainment.com for product support.

What's in the Box

- FUSION Panel-Stereo
- Stereo trim
- Six 6-gauge, self-tapping stainless steel screws
- Power wiring harness

Tools Needed

- Electric drill
- Drill bit (size varies based on surface material)
- Phillips screwdriver
- Wire strippers
- Crimping tool
- Electrical tape
- Appropriate saw or utility knife to cut surface material
- Marine sealant (optional)

NOTE: For customized installations, additional tools and materials may be needed.

Mounting Considerations

NOTICE

Selecting the correct mounting location is critical to optimize the performance of the stereo. FUSION stereos are designed to perform in the widest possible range of mounting locations, but the more you plan the installation, the better the stereo's sound will be.

NOTE: If you install the optional mounting spacer, you must use the six black screws supplied with the mounting spacer to mount the stereo to the mounting spacer.

- Using the included screws, this stereo can be flush mounted in a surface with a depth of at least 50 mm (2 in.)
- Using an optional spacer (sold separately), this stereo can be mounted directly on a flat surface.
- To ensure water does not enter between the stereo and mounting surface, you should use marine sealant when mounting the stereo.
- For the best performance, the stereo should not be mounted low in the vehicle or vessel. Sound travels in the direction in which the stereo is facing. When the stereo is mounted low, the sound quality and volume are not ideal.
- For the best seal, you should select a flat mounting surface.
- The mounting location must avoid potential obstacles, such as fuel and hydraulic lines and wiring.
- The cable should have a drip loop to allow water to drip down off the cable and avoid damaging the stereo.
- The Panel-Stereo should be mounted in a location that is not exposed to direct sunlight for prolonged periods of time. The Panel-Stereo Outdoor can be mounted in a location that is exposed to direct sunlight for prolonged periods of time.
- To avoid interference with a magnetic compass, the stereo should not be installed closer to a compass than the compass-safe distance value listed in the product specifications.
- You should protect the stereo wires from sharp objects and always use rubber grommets when wiring through panels.
- You should protect all terminals and connections from grounding and from each other. Failure to do so could result in permanent damage to the audio system and void the product warranty.

Mounting the Stereo

Before mounting the stereo, you must choose a location where there is enough clearance behind the mounting surface. Refer to the side view drawings for clearance information.

If necessary, you can purchase a spacer (not included) to install the stereo directly onto a flat surface.

Before mounting the stereo, you must choose a location following the guidelines above.

- 1 Trim the template and make sure it fits in the selected location.
- 2 Secure the template to the selected location.
- 3 Using a drill bit appropriate for the mounting surface, drill a hole inside the dashed line on the template to prepare the mounting surface for cutting.
- 4 Using a jigsaw or rotary tool, cut the mounting surface along the inside of the line on the template.
- 5 Place the stereo in the cutout to test the fit.
- 6 If necessary, use a file and sandpaper to refine the size of the cutout.
- 7 After the stereo fits correctly in the cutout, ensure the mounting holes on the stereo line up with the pilot holes on the template.
- 8 If the mounting holes on the stereo do not line up, mark the new hole locations.
- 9 Using an appropriately sized drill bit for the mounting surface and screw type, drill the holes.
- 10 Remove the template from the mounting surface.
- 11 Make the necessary wiring connections ([Connector Identification, page 2](#)).
- 12 Place the stereo ① in the cutout ②.

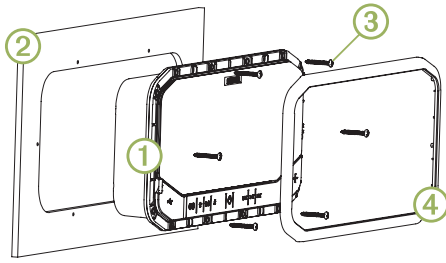

13 If there is a concern that water may enter the mounting surface around the edges of the stereo, apply marine sealant around each of the screw holes and between the stereo and the mounting surface (optional).

NOTICE

Do not apply grease or lubricant to the screws when fastening the stereo to the mounting surface. Grease or other lubricants can cause damage to the stereo housing.

14 Secure the stereo to the mounting surface using the included screws **3**, or screws appropriate for the depth of the mounting surface.

NOTE: Do not over tighten the screws, especially if the mounting surface is not flat.

15 Press the trim **4** firmly onto the stereo until all of the pins snap into place.

Connector Identification

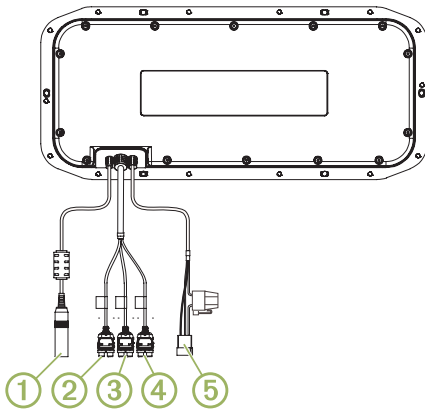

Item	Connector	Connects to
1	External antenna	External AM/FM antenna
2	AUX IN 1	Audio sources, such as a CD player, TV, or another FUSION stereo
3	AUX IN 2	Audio sources, such as a CD player, TV, or another FUSION stereo
4	Line out	RCA line out, switchable between variable and fixed output
5	Power	12 V +, -/ground, and external amplifier on

Connecting to Power

When connecting the stereo to power, you should connect it through the ignition or another manual switch.

If it is necessary to extend the power and ground wires, use 14 AWG (2.08 mm²) wire. For extensions longer than 1 m (3 ft.), use 12 AWG (3.31 mm²) wire.

1 Route the red power wire **1** to the ignition or another manual switch **2**, and route the black ground wire **3** to the battery.

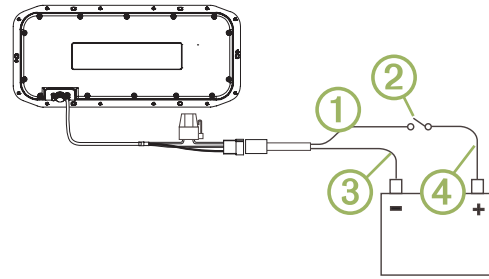

2 If necessary, route a wire **4** between the switch and the battery .

3 Route the wiring-harness plug to the stereo.

Do not connect the wiring harness to the stereo until after all of the bare wire connections have been made.

4 Connect the black wire to the negative (-) battery terminal.

5 Connect the red power wire to the ignition or another manual switch, and connect the switch to the positive (+) battery terminal if necessary.

6 Connect the wiring harness plug to the stereo.

Stereo Information

Registering Your FUSION Panel-Stereo

Help us better support you by completing our online registration today.

- Go to www.fusionentertainment.com.
- Keep the original sales receipt, or a photocopy, in a safe place.

Cleaning the Stereo

NOTE: This stereo is rated IP65 for protection in harsh environments. It is not designed to withstand high pressure water spray, which may occur when you wash down your vehicle or vessel. Failure to carefully spray-clean the vehicle or vessel may damage the product and void the warranty.

NOTICE

Do not use harsh or solvent-based cleaners on the stereo. Using such cleaners may damage the product and void the warranty.

1 Clean all salt water and salt residue from the stereo grille with a damp cloth soaked in fresh water.

2 Use a mild detergent to remove a heavy buildup of salt or stains.

Dimension Drawings

Rear View

Dimensions are shown without the trim attached.

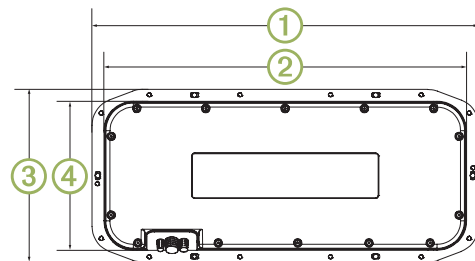

Dimension	Measurement
1	341 mm (13.43 in.)
2	320 mm (12.61 in.)
3	152 mm (6 in.)
4	132 mm (5.19 in.)

Side View

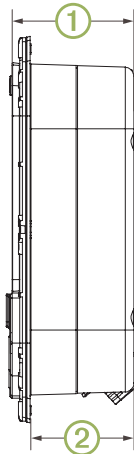

Dimension	Measurement
①	50 mm (1.97 in.)
②	41 mm (1.6 in.)

Specifications

Ingress protection rating*	IEC 60529 IP65
Dimensions with trim (W × H × D)	344 x 155 x 50 mm (13.54 x 6.1 x 1.97 in.)
Weight	1.15 kg (2.54 lb.)
Operating temperature range	From 0° to 50°C (from 32° to 122°F)
Long-term storage temperature range	From -20° to 70°C (from -4° to 158°F)
Bluetooth® wireless range	Up to 10 m (33 ft.)
ANT® wireless range	Up to 3 m (10 ft.)
Input voltage	From 10.8 to 16.0 Vdc
Current (max.)	10 A
Fuse	10 A
Line output level (max.) (peak to peak)	5.5 V
Aux. input level (typical) RMS	1 V

*IP rating does not include rear connectors.

Compass-Safe Distances

All stereo speakers contain magnets which may cause interference with instruments on your vehicle or vessel. The size of the magnet used in the stereo speakers affects how much interference the stereo speakers may cause.

Interference can cause deviations and variations in the readings of sensitive navigational equipment, such as magnetic compasses. These deviations can cause inaccuracies or offsets in the readings, but will not harm the equipment. To alleviate the deviations, adjust the compass for the deviation following the manufacturer's instructions or move the stereo away from the navigational equipment. After moving a source of interference, you may need to recalibrate the compass.

If you are navigating solely by a magnetic compass, use extreme caution to place the stereo far enough away from the compass to avoid causing deviations in the readings.

To avoid deviations to navigational equipment, position the stereo so it is separated from the navigational equipment by at least the distances listed in the table below.

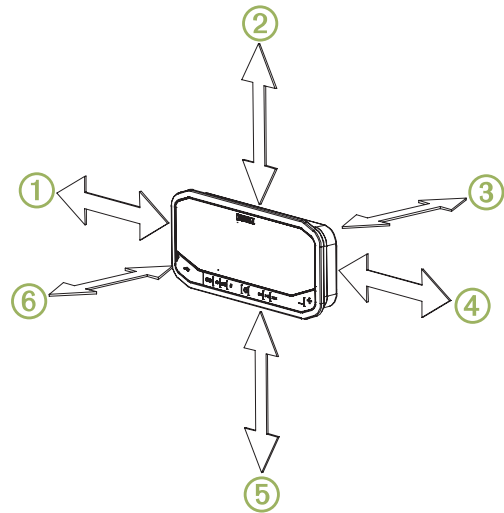

Direction from Speaker	Compass-safe Distance
①	122 cm (4 ft.)
②	105 cm (3.5 ft.)
③	229 cm (7.6 ft.)
④	138 cm (4.5 ft.)
⑤	112 cm (3.8 ft.)
⑥	214 cm (7 ft.)

Troubleshooting

Before you contact your FUSION dealer or service center, you should perform a few simple troubleshooting steps to help diagnose the problem.

If the FUSION stereo has been professionally installed, you should contact the installer so a technician can assess the problem and advise you about possible solutions.

The audio is distorted

- Verify that the panels surrounding the stereo on the vehicle or vessel are not rattling.
- Verify that the source volume is not too loud, and reduce the volume if necessary.
- Verify that all RCA connections are in good condition, and the connectors are insulated from each other.
- Verify that all cables are properly attached.

© 2018 Garmin Ltd. or its subsidiaries

Garmin®, the Garmin logo, FUSION®, the Fusion logo, and True-Marine™ are trademarks of Garmin Ltd. or its subsidiaries, registered in the USA and other countries. These trademarks may not be used without the express permission of Garmin.

